

Features :

**1) Outward Open**

When we open clipping classic buckles, the clip of the buckle is pushed inside. Contrary to the classic buckle, the clip of our product is not pushed BUT pulled and opened OUTSIDE.

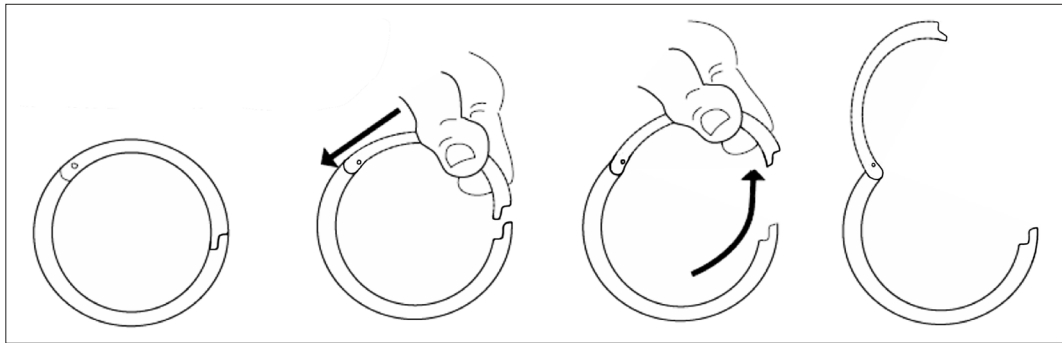

**2) On Purpose**

The clip of a classic buckle can be opened by accident, BUT the clip of our product can ONLY be opened on purpose.

**3) Fully Opened**

When we combine the buckle with a bag, we hook it into the bag and return the clip to the initial position. If we use a classic buckle, after hooking the bag, the clip is often blocked by the bag itself. It is difficult to close the clip. However, since the clip of our product is opened outside and fully opened, it is very simple to close the clip after hooking.

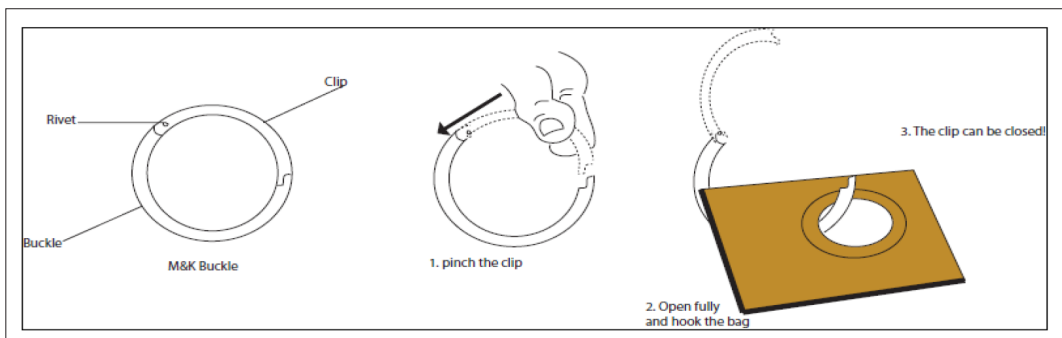
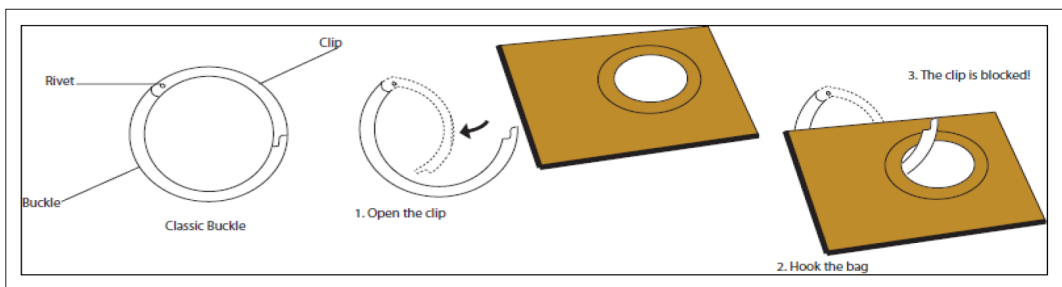

Category : リング (Ring)  
: 外開きリング (Outward Open)

丸線形状 (Round Shape)

**KHA-13-36**

内径 (ID) : 36mm  
外径 (OD) : 50mm



KHA-13- 36 / 30 / 24 / 21

**KHA-13-30**

内径 (ID) : 30mm  
外径 (OD) : 42mm



KHA-13-36

**KHA-13-24**

内径 (ID) : 24mm  
外径 (OD) : 34mm



KHA-13-30

**KHA-13-21**

内径 (ID) : 21mm  
外径 (OD) : 30mm



KHA-13-24



KHA-13-21

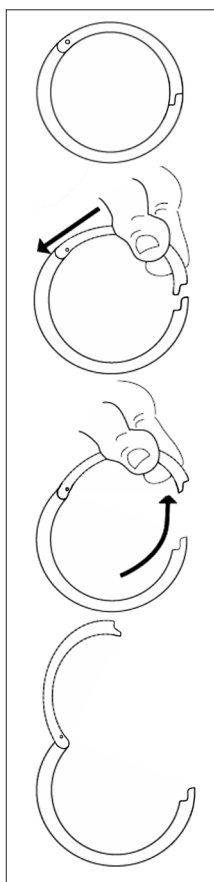

Category : リング (Ring)  
: 外開きリング (Outward Open)

角線形状 (Square Shape)

**KHA-24-36**

内径 (ID) : 36mm  
外径 (OD) : 48mm



KHA-24- 36 / 30 / 24

**KHA-24-30**

内径 (ID) : 30mm  
外径 (OD) : 40mm



KHA-24-36



KHA-24-30

**KHA-24-24**

内径 (ID) : 24mm  
外径 (OD) : 34mm



KHA-24-24

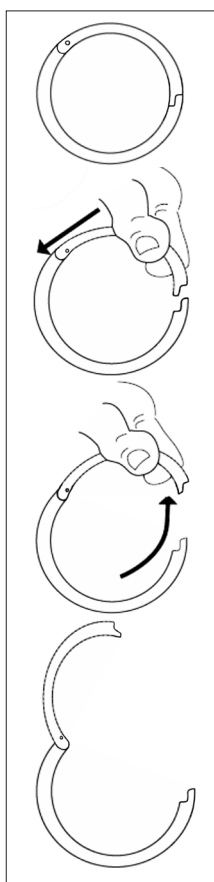

Category : 小判 (Oval Ring)  
 : 外開きリング (Outward Open)

**M&K YOKOYA**  
<http://www.mk-yokoya.co.jp/>

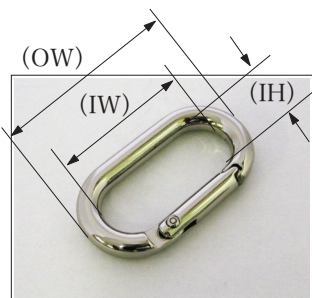

KHA-28-25 KHA-37



Size / mm

	(IW) × (OW) × (IH)
KHA-28-25	25 × 33 × 10
KHA-37	25 × 37 × 10



KHA-28-25



KHA-37



Category : ナスカン (Swivel Clasp : Clipping Buckle System)  
 : 外開きナスカン (Outward Open)

**M&K YOKOYA**  
<http://www.mk-yokoya.co.jp/>

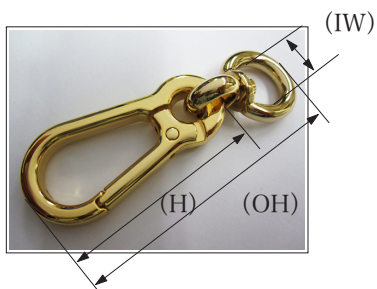

KHA-11-15



KHA-14-15

**Size / mm**

	(IW) × (H) × (OH)
KHA-11-15	15 × 59 × 86
KHA-14-15	15 × 44 × 70
KHA-11	8 × 59
KHA-14	6 × 44



KHA-11-15 / KHA-14-15

**Diagram**

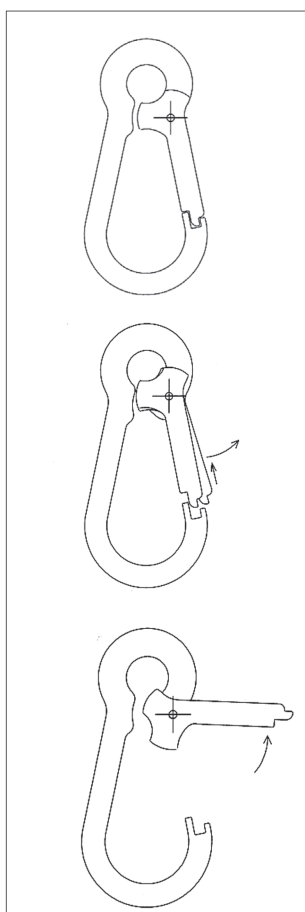

KHA-11



KHA-14



Category : ナスカン (Swivel Clasp : Clipping Buckle System)

: 外開きナスカン (Outward Open)

**M&K YOKOYA**

<http://www.mk-yokoya.co.jp/>

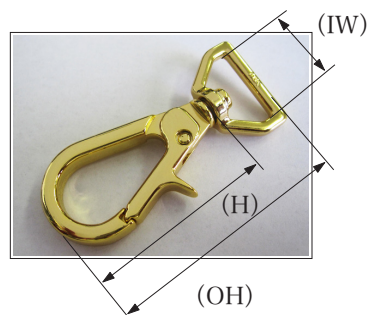

**Size / mm**

	(IW) × (H) × (OH)
NA-143-30T	30 × 41 × 59
NA-143-24T	24 × 41 × 59
NA-143-21T	21 × 41 × 58
NA-143-18T	18 × 41 × 58
NA-143-15T	15 × 41 × 56
NA-143-18	18 × 41 × 59
NA-143-10	10 × 41 × 58



NA-143-30T



NA-143-24T



NA-143-21T

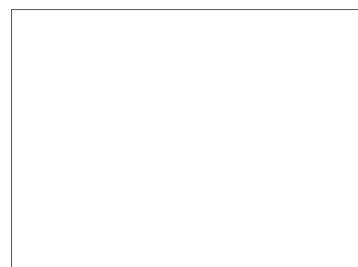

NA-143-18T



NA-143-18



NA-143-15T



NA-143-10



NA-143-10 / 18

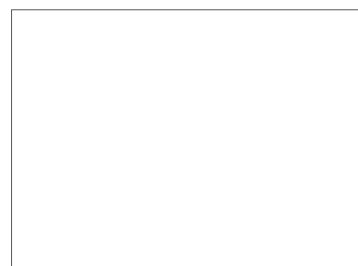

Category : ナスカン (Swivel Clasp : Clipping Buckle System)

: 外開きナスカン (Outward Open)

**M&K YOKOYA**

<http://www.mk-yokoya.co.jp/>

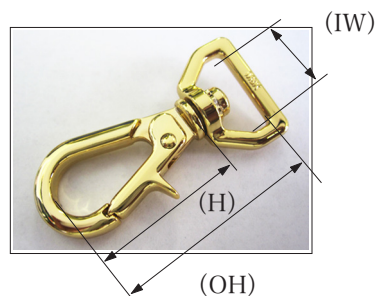

**Size / mm**

	(IW) × (H) × (OH)
NA-146-21T	21 × 30 × 47
NA-146-18T	18 × 30 × 47
NA-146-15T	15 × 30 × 45
NA-146-12T	12 × 30 × 45
NA-146-10	10 × 30 × 46



NA-146-21T



NA-146-18T



NA-146-15T



NA-146-12T

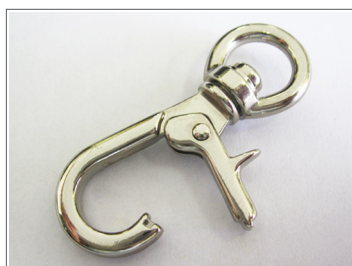

NA-146-10



Category : リング (Swivel Clasp)  
 : 外開きリング (Outward Open)

**M&K YOKOYA**  
<http://www.mk-yokoya.co.jp/>

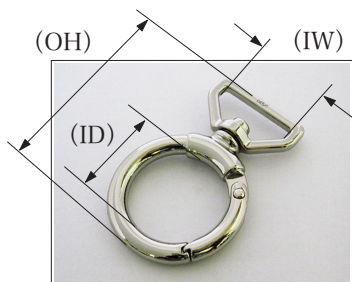

**Size / mm**

	(IW) × (ID) × (OH)
KHA-35-21T	21 × 24 × 52
KHA-35-18	18 × 24 × 54
KHA-35-18T	18 × 24 × 52
KHA-35-15T	15 × 24 × 51
KHA-35-10	10 × 24 × 52



KHA-35-21T



KHA-35-21T

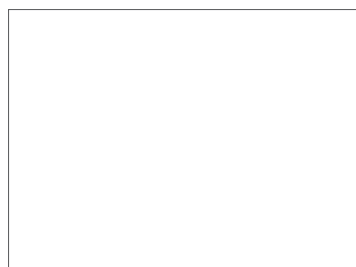

KHA-35-18



KHA-35-18T



KHA-35-15T

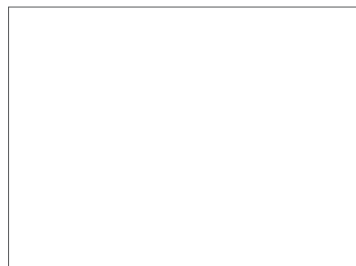

KHA-35-10

